

Lumos Hawk 100F

➤ Small but Powerful Fresnel Light

- CRI 97 Ra at 3200K / 95 Ra at 5600K
- 600W Output
- 12~24V DC Free volt
- Compatible with wide range of batteries
- 15°~50° Beam angle
- Flicker free
- Stable dimming (0~100%)
- Standard DMX 512
- Suitable for the field and small studio



➤ Photometric information of Lumos Hawk 100F

| CCT | Beam angle | 4 ft | 8 ft | 12 ft | 16 ft | 20 ft | 1m | 2m | 3m | 4m | 5m |
|-------|-------------|----------|--------|--------|--------|--------|------------|-----------|-----------|-----------|-----------|
| 3200K | Spot (15°) | 1,808 Fc | 510 Fc | 241 Fc | 139 Fc | 90 Fc | 28,930 lux | 8,173 lux | 3,857 lux | 2,224 lux | 1,447 lux |
| | Flood (50°) | 364 Fc | 102 Fc | 48 Fc | 28 Fc | 18 Fc | 5,830 lux | 1,647 lux | 777 lux | 448 lux | 292 lux |
| 5600K | Spot (15°) | 2,138 Fc | 604 Fc | 285 Fc | 164 Fc | 106 Fc | 34,208 lux | 9,664 lux | 4,561 lux | 2,630 lux | 1,710 lux |
| | Flood (50°) | 398 Fc | 109 Fc | 51 Fc | 30 Fc | 19 Fc | 6,210 lux | 1,754 lux | 828 lux | 477 lux | 311 lux |

➤ Lumos Hawk 100F Specifications

| | | |
|--------------------|---|-------|
| Power Consumption | 100W Nominal / 110W Maximum | |
| Size | W229 * H280 * L281 (mm) W9.0 * H11.0 * L11.0 (inch) | |
| Weight | 4.5 kg / 9.9 lb | |
| Color Temperature | 3200K or 5600K | |
| E. Characteristics | AC 100~240V / 50~60Hz | |
| Input Voltage | 12~24V DC (Free volt) | |
| Dimming | 0~100% Manual / DMX 512 | |
| Flicker | Flicker free | |
| Fresnel lens | 120mm (4.72") PMMA Fresnel lens | |
| Beam angle | 15° ~ 50° | |
| Cooling system | Hybrid cooling system (fan) | |
| Operating Temp. | 0°C ~ 45°C | |
| Accessory | <ul style="list-style-type: none"> • V-mount / G-mount bracket • 4-leaf barndoor • Pole operated yoke (Panning / Tilting) • Diffusing filter | |
| Color temperature | 3200K | 5600K |
| CCT Tolerance | ±150K | ±150K |
| CRI | 97 Ra | 95 Ra |

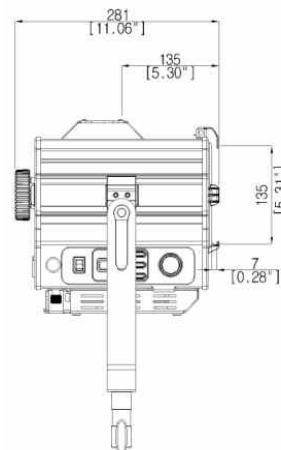
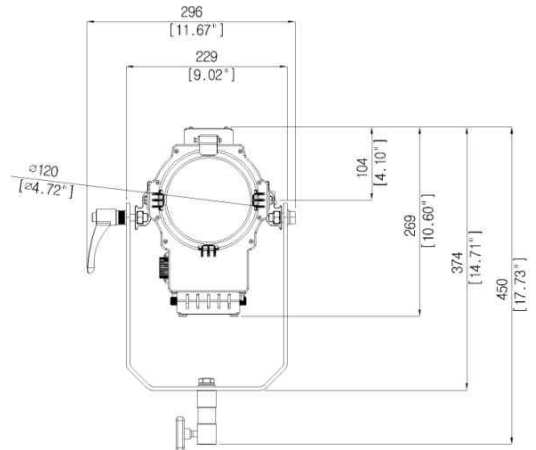

Lumos Hawk

➤ decibel measurements of Lumos Hawk Series

| Model | 1m | 2m | 3m |
|--------------------------------------|-------|-------|-------|
| Lumos Hawk 400 400W | 28 dB | 24 dB | 22 dB |
| Lumos Hawk 200 / 200A 200W / 220W | 21 dB | 19 dB | 18 dB |
| Lumos Hawk 100 100W | 20 dB | 19 dB | 18 dB |

Hybrid cooling system

The patented technology to improve air flow to cool down the heat created inside the product.

Usually the convection heat mode is at low dimming stage.

However fan will be turned on at certain dimming stage as below.

- Hawk 400 : Cube 86~100%, Linear 61~100%, Root 28~100%
- Hawk 200 : Cube 93~100%, Linear 76~100%, Root 39~100%
- Hawk 100 : Cube 80~100%, Linear 51~100%, Root 22~100%

➤ Mode

| Mode | Function |
|------------------|--|
| Dimming | <ul style="list-style-type: none"> • Stable Dimming (0~100%) • Enable to customize the dimming step as each 1% or 4~5% |
| Dimming curve | <ul style="list-style-type: none"> • Customized dimming steps are available • 3-way Dimming curve select to mode button <ul style="list-style-type: none"> ➤ Linear type : Normal increase of lighting intensity ➤ Cube type : Detailed control in Low dimming area (0~50%) ➤ Root type : Detailed control in high dimming area (50~100%) <div style="text-align: center;"> <p>Dimming Curve</p> </div> |
| DMX channel | <ul style="list-style-type: none"> • Standard DMX 512 • Compatibility with various DMX Controllers • Firmware available for most DMX Controllers • Change DMX channel (1~512) |
| 12~24V Free volt | <ul style="list-style-type: none"> • Compatible with wide range of batteries. • V-mount battery or Gold-mount battery |

Lumos Hawk

➤ Photometric information of Lumos Hawk Series (F type)

| Model | Beam angle | | | 1m | 2m | 3m | 4m | 5m |
|-------------------------|--------------|---------------|-------|-------------|------------|------------|------------|-----------|
| Lumos Hawk 400F 400W | Spot 15° | Illumination | 3200K | 185,995 lux | 49,285 lux | 21,905 lux | 12,320 lux | 7,885 lux |
| | | | 5600K | 205,195 lux | 54,375 lux | 24,165 lux | 13,590 lux | 8,700 lux |
| | | Beam diameter | | 0.50 m | 0.77 m | 1.03 m | 1.29 m | 1.56 m |
| | Flood 50° | Illumination | 3200K | 25,780 lux | 6,830 lux | 3,035 lux | 1,705 lux | 1,090 lux |
| | | | 5600K | 28,485 lux | 7,545 lux | 3,355 lux | 1,885 lux | 1,205 lux |
| | | Beam diameter | | 1.17 m | 2.10 m | 3.04 m | 3.97 m | 4.90 m |
| Lumos Hawk 200F 200W | Spot 15° | Illumination | 3200K | 51,420 lux | 14,526 lux | 6,856 lux | 3,953 lux | 2,571 lux |
| | | | 5600K | 61,850 lux | 17,520 lux | 8,190 lux | 4,725 lux | 3,048 lux |
| | | Beam diameter | | 0.46 m | 0.73 m | 1.00 m | 1.27 m | 1.54 m |
| | Flood 50° | Illumination | 3200K | 8,205 lux | 2,318 lux | 1,094 lux | 631 lux | 410 lux |
| | | | 5600K | 11,120 lux | 2,580 lux | 1,386 lux | 769 lux | 485 lux |
| | | Beam diameter | | 1.13 m | 2.06 m | 3.00 m | 3.95 m | 4.87 m |
| Lumos Hawk 200A 220W | Spot 15° | Illumination | 3200K | 61,704 lux | 17,431 lux | 8,227 lux | 4,744 lux | 3,085 lux |
| | | | 5600K | 74,220 lux | 21,024 lux | 9,828 lux | 5,670 lux | 3,658 lux |
| | | Beam diameter | | 0.46 m | 0.73 m | 1.00 m | 1.27 m | 1.54 m |
| | Flood 50° | Illumination | 3200K | 11,979 lux | 3,384 lux | 1,597 lux | 921 lux | 599 lux |
| | | | 5600K | 16,235 lux | 3,767 lux | 2,024 lux | 1,123 lux | 708 lux |
| | | Beam diameter | | 1.13 m | 2.06 m | 3.00 m | 3.95 m | 4.87 m |
| Lumos Hawk 150F 150W | Spot 15° | Illumination | 3200K | 44,100 lux | 12,458 lux | 5,880 lux | 3,390 lux | 2,205 lux |
| | | | 5600K | 52,500 lux | 14,831 lux | 7,000 lux | 4,036 lux | 2,625 lux |
| | | Beam diameter | | 0.46 m | 0.73 m | 1.00 m | 1.27 m | 1.54 m |
| | Flood 50° | Illumination | 3200K | 6,740 lux | 1,904 lux | 899 lux | 518 lux | 337 lux |
| | | | 5600K | 8,190 lux | 2,314 lux | 1,092 lux | 630 lux | 410 lux |
| | | Beam diameter | | 1.13 m | 2.06 m | 3.00 m | 3.95 m | 4.87 m |
| Lumos Hawk 100F 100W | Spot 15° | Illumination | 3200K | 28,930 lux | 8,173 lux | 3,857 lux | 2,224 lux | 1,447 lux |
| | | | 5600K | 34,208 lux | 9,664 lux | 4,561 lux | 2,630 lux | 1,710 lux |
| | | Beam diameter | | 0.38 m | 0.65 m | 0.91 m | 1.17 m | 1.44 m |
| | Flood 50° | Illumination | 3200K | 5,830 lux | 1,647 lux | 777 lux | 448 lux | 292 lux |
| | | | 5600K | 6,210 lux | 1,754 lux | 828 lux | 477 lux | 311 lux |
| | | Beam diameter | | 1.05 m | 1.99 m | 2.92 m | 3.85 m | 4.78 m |
| Lumos Hawk 50F 50W | Spot 15° | Illumination | 3200K | 20,500 lux | 5,791 lux | 2,733 lux | 1,576 lux | 1,025 lux |
| | | | 5600K | 22,000 lux | 6,215 lux | 2,933 lux | 1,691 lux | 1,100 lux |
| | | Beam diameter | | 0.38 m | 0.65 m | 0.91 m | 1.17 m | 1.44 m |
| | Flood 50° | Illumination | 3200K | 5,530 lux | 1,562 lux | 737 lux | 426 lux | 277 lux |
| | | | 5600K | 5,970 lux | 1,687 lux | 796 lux | 459 lux | 299 lux |
| | | Beam diameter | | 1.05 m | 1.99 m | 2.92 m | 3.85 m | 4.78 m |

Lumos Hawk

➤ Photometric information of Lumos Hawk Series (MK type)

| Model | | Beam angle | | 1m | 2m | 3m | 4m | 5m |
|--------------------------|------------|---------------|-------|------------|------------|-----------|-----------|-----------|
| Lumos Hawk 200MK 220W | Spot (15°) | Illumination | 3200K | 35,906 lux | 10,143 lux | 4,787 lux | 2,760 lux | 1,795 lux |
| | | | 5600K | 51,625 lux | 14,624 lux | 6,836 lux | 3,944 lux | 2,544 lux |
| | | Beam diameter | | 0.46 m | 0.73 m | 1.00 m | 1.27 m | 1.54 m |
| | Flood 50° | Illumination | 3200K | 7,872 lux | 2,224 lux | 1,050 lux | 605 lux | 393 lux |
| | | | 5600K | 10,802 lux | 2,506 lux | 1,346 lux | 747 lux | 471 lux |
| | | Beam diameter | | 1.13 m | 2.06 m | 3.00 m | 3.95 m | 4.87 m |
| Lumos Hawk 150MK 150W | Spot (15°) | Illumination | 3200K | 27,835 lux | 7,863 lux | 3,711 lux | 2,140 lux | 1,392 lux |
| | | | 5600K | 38,960 lux | 11,006 lux | 5,195 lux | 2,995 lux | 1,948 lux |
| | | Beam diameter | | 0.46 m | 0.73 m | 1.00 m | 1.27 m | 1.54 m |
| | Flood 50° | Illumination | 3200K | 6,055 lux | 1,710 lux | 808 lux | 465 lux | 303 lux |
| | | | 5600K | 8,125 lux | 2,296 lux | 1,083 lux | 625 lux | 407 lux |
| | | Beam diameter | | 1.13 m | 2.06 m | 3.00 m | 3.95 m | 4.87 m |
| Lumos Hawk 100MK 100W | Spot (15°) | Illumination | 3200K | 10,750 lux | 2,688 lux | 1,208 lux | 672 lux | 430 lux |
| | | | 5600K | 15,230 lux | 3,808 lux | 1,742 lux | 952 lux | 609 lux |
| | | Beam diameter | | 0.38 m | 0.65 m | 0.91 m | 1.17 m | 1.44 m |
| | Flood 50° | Illumination | 3200K | 4,210 lux | 1,053 lux | 524 lux | 263 lux | 168 lux |
| | | | 5600K | 6,555 lux | 1,639 lux | 804 lux | 410 lux | 262 lux |
| | | Beam diameter | | 1.05 m | 1.99 m | 2.92 m | 3.85 m | 4.78 m |
| Lumos Hawk 50MK 50W | Spot (15°) | Illumination | 3200K | 9,650 lux | 2,413 lux | 1,218 lux | 603 lux | 386 lux |
| | | | 5600K | 11,830 lux | 2,958 lux | 1,489 lux | 952 lux | 609 lux |
| | | Beam diameter | | 0.38 m | 0.65 m | 0.91 m | 1.17 m | 1.44 m |
| | Flood 50° | Illumination | 3200K | 2,740 lux | 685 lux | 357 lux | 171 lux | 110 lux |
| | | | 5600K | 3,242 lux | 811 lux | 728 lux | 410 lux | 262 lux |
| | | Beam diameter | | 1.05 m | 1.99 m | 2.92 m | 3.85 m | 4.78 m |